



SAINT-GOBAIN



PRODUCT PORTFOLIO

🌐 www.abe.co.za ☎ 086 0223 773



SAINT-GOBAIN



- Waterproofing
- Concrete Repair and Protection
- Concrete Works
- Flooring
- Sealants and Adhesives

Content

	PAGE
Profile	02-03
Construction Map	04-05
Product Selectors	06-15

a.b.e.®, a division of the Saint-Gobain Group specializes in products and systems for construction, waterproofing, flooring, and concrete repair.

a.b.e.® provide solutions that address various construction needs, including infrastructure projects, residential buildings, and industrial applications.



To view the **a.b.e.**® website, scan this QR code with your smartphone.



WATERPROOFING SOLUTIONS



CONCRETE REPAIR & PROTECTION



CONCRETE WORKS



SEALANTS & ADHESIVES



FLOORING SOLUTIONS



a.b.e.® was founded in 1932 but started operations in 1939 in Durban as a supplier of bitumen to municipalities in KwaZulu-Natal. **a.b.e.**® has over the years grown in both size and diversity to become a major supplier of specialised construction products to the building, civil engineering and building maintenance industries, supplying products directly to customers through its branch network as well as through builders' merchants and hardware stores.

a.b.e.® has manufacturing plants in Gauteng and KwaZulu-Natal. Supported by a network of branches and distributors throughout South Africa, sub-Saharan Africa, the Indian Ocean Islands, **a.b.e.**® is ideally positioned to service its customers.

a.b.e.® is a Saint-Gobain brand that cares about building better for people and the planet, while addressing a variety of markets in construction and renovation.

Saint-Gobain designs, manufactures and distributes materials and solutions for the construction, mobility and industrial markets.

Developed through a continuous innovation process, our integrated solutions provide sustainability and performance in daily life, addressing the renovation of public and private buildings, light construction and the decarbonization of construction and industry.

In this way, we contribute to reducing carbon emissions, leveraging resource efficiency and increasing circularity.

Sales Channels:

Construction Sales

This channel focuses on sales to general contractors ranging from large construction companies to the small house builder, as well as specifiers, developers, facility managers and various engineers.

Retail Sales

The retail customer base comprises hardware and building supply outlets ranging from the large groups with a national footprint, to the small corner hardware store. Agricultural co-ops are also included, along with several agents and distributors who operate in defined markets.

MAKING THE WORLD A BETTER HOME

CONSTRUCTION MARKET

We care about building better for people and the planet by offering solutions that deliver sustainability and performance to drive the transformation of the construction market.

MOBILITY MARKET

Whether ground-based or within aerospace, we engineer high performance solutions to create individual and collective transportation that are safe, sustainable and performant for the comfort of all.

INDUSTRIAL MARKET

Based on our material expertise, co-development with customers and digitalization, we develop solutions to create a more performant and more sustainable industry. We help our customers to accelerate their energy transition roadmap and improve the wellbeing of all with our healthcare solutions.

Export Sales

Our export channel operates out of the **a.b.e.**® Head Office in Johannesburg and provides specialised services and support to its Sub-Saharan African markets.

Currently **a.b.e.**® has representation in Botswana, Namibia, Mozambique, Zimbabwe, Malawi, Ghana, Zambia, Mauritius, Madagascar, Angola, Kenya and Ghana.





SAINT-GOBAIN

Infrastructure Solutions

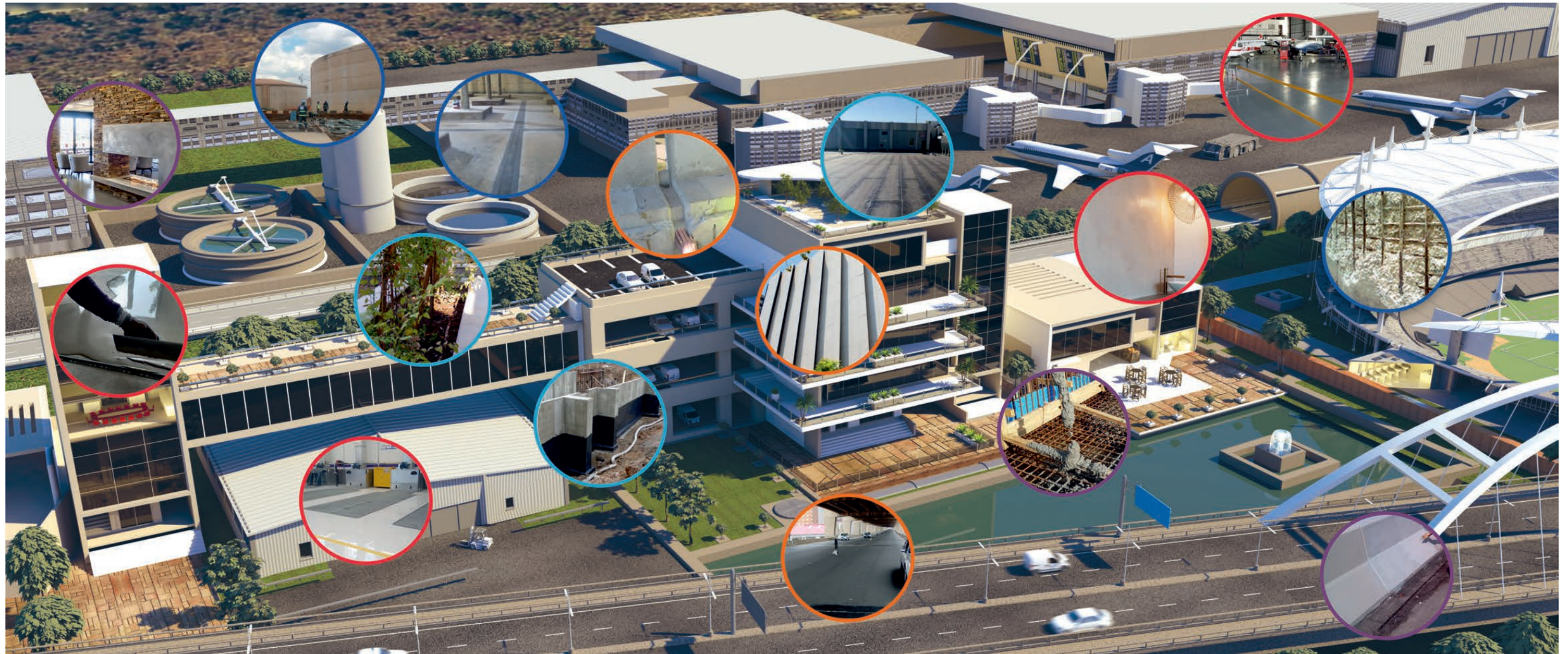

WATER-PROOFING SOLUTIONS

- Liquid Applications
- Torched Membranes
- Cold Applied Membranes
- Drainage Membranes
- Eco Waterproofing

CONCRETE REPAIR & PROTECTION

- Crack Repair
- Fairing & Reprofilling
- Primers & Adhesives
- Protective Coatings
- Repair Mortars
- Structural Reinstatement

CONCRETE WORKS

- Priming & Bonding
- Coatings & Sealers
- Curing & Release Aids
- Grouting & Anchoring
- Waterstops & Bandage

FLOORING SYSTEMS

- Dry Shakes
- Coatings
- Screeds
- Case Hardening
- Adhesives & Primers
- Coving & Cleaning

SEALANTS & ADHESIVES

- Joint & General Sealing
- Adhesives
- Manhole Sealants & Butyls
- Structural & Insulated Glazing
- Panel Bonding

PRODUCT SELECTOR

WATERPROOFING SOLUTIONS



To view all products, scan this QR code with your smartphone.

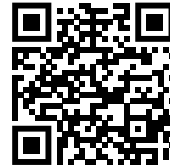

LIQUID APPLICATIONS			
Parapet wall encapsulation	Economical, kit, range of colours	Acrylic	hydroproof®
Primer for bitumen overlays or coatings	Consolidation of surface and preparation	Bitumen	bituprime
Showers, fish ponds, reservoirs, water structures	Elastomeric, potable water, grey	Cementitious	duraflex®
Concrete, plaster and brick surfaces, dams, ponds, basements, sewage plants, supporting walls	Internal and external, potable water, grey, rigid		duraslurry
Protective coatings for bitumen	Flexible, light reflective, UV protection	Bitumen/Aluminium	silvakote®, silvakote® eco
Flashings, parapet walls, protective coating, sealing of joints, laps and roof screws on corrugated roofs	Flexible, coloured, UV protection, excellent weathering	Bitumen/Acrylic	super laycryn®
Flashings, fish ponds, earth dam linings, areas of total immersion, joints, laps, roof screws on corrugated roofs	Flexible, rubberised, potable water	Bitumen	super laykold®
Concrete beams and pillars in contact with exterior brickwork, waterproof barrier	Flexible, heavy duty, single pack, quick drying		brixeal
Heavy duty mastic sealer and repair compound to seal most roofing defects	Solvent based, asbestos free, reinforced bituminous mastic		bituseal plastic
Water repellent for concrete and masonry	Clear, non-staining	Silane/Siloxane	wallseal
Solvent borne, liquid primer applied to most building substrates	Excellent surface conditioner, durable, quick drying, moisture insensitive	Solvent	abeproof liquid membrane primer
Solvent borne, liquid waterproofing membrane suitable for most building substrates	Highly elastic, durable, low VOC, rubberised, low maintenance		abeproof liquid membrane
TORCH APPLIED MEMBRANES			
Used as a single layer system or as part of a multi-layer in both the refurbishment and new building works market	Polymer modified bitumen reinforced with a composite reinforcement	Bitumen membrane	abe® torch-on 4 mm
On all sloping surfaces; flat, vertical and curved. On different types of substrates			abedex® V-SR 4 mm
General waterproofing, flat roofs (suited for hotter climatic conditions)	Twin carrier, low maintenance, mineral surface		abedex® unigum Mineral Slate
General waterproofing, flat roofs, (suited for hotter climatic conditions)	Twin carrier, smooth surface, hard compound strength		abedex® unigum® 4 mm
Roof gardens and planter boxes, Basement tanking	Anti-root protection Rot proof		abedex® AR
Flat and inverted roof systems, dam linings	Flexible compound strength		abedex® FS-R
Flat and inverted roof systems	Low maintenance, mineral surface		abedex® FS-R Mineral Slate
Expansion joints	High movement		abedex® HM
Under trafficable overlays, asphalt, pavers etc.	Excellent heat and abrasion resistance, hot asphalt tolerant		abedex® AT

COLD APPLIED MEMBRANES			
Geotextile for drainage, filtration, separation and protection	Non-woven, needle-punched, continuous filament	Polyester	Bidim®
Reinforcing membrane for a.b.e.® cementitious waterproofing systems i.e. duraflex®	Non-woven, needle-punched, continuous filament	Polypropylene	ecofelt
Polymer bonded E-glass yarn	55 gram scrim, versatile force of reinforcement that will increase the coating strength and reduce cracking.	Fibreglass	abeflex
Damp proofing	2 ply, 3 ply, 5 ply	Bitumen membrane	Malthoid 2 ply, Malthoid 3 ply, Malthoid 5 ply
Slate roofing	Aluminium faced waterproofing		slatex® 2000
Low thresholds, waterproofing floor areas of patio's, balconies, wet areas in kitchens, bathrooms and showers to receive tile adhesive and tiling	Universal, self-adhesive, alkali resistant		abe® peel and stick membrane
Flashing tapes	Self-adhesive, aluminium faced		super laykold® waterproofing tape
DRAINAGE			
Protects bituminous membranes in walls, basements, and foundations. Also as separation layer to control water flow for terraces, flat roofs, roof gardens, tanking	Dimpled high-density polyethylene protection membrane, high resistance to all chemical agents found in soil and groundwater and to mechanical compression	HDPE membrane and geotextile	abedrain® (8mm)
Roof gardens and planter boxes to prevent water stagnation	Dimples retain water and excess water is drained – anti-stagnation		abedrain® G
Roof gardens and planter boxes to prevent water stagnation	Dimples retain water and excess water is drained – anti-stagnation	HDPE membrane and perforations	abedrain® 20 P
Terraces, flat roofs, roof gardens and planters, retaining walls, tanking	20 mm raised dimple for extra drainage capacity	HDPE membrane	abedrain® 20
ECO WATERPROOFING			
Existing and new roof areas	Flexible, crack bridging, UV resistant, low VOC	Acrylic	abeproof acrylic
Primer, sealer and bonding agent for a.b.e.®proof liquid acrylic systems	Water based, non-toxic and excellent bonding		abeproof acrylic primer
Concrete deck waterproofing	Seamless coating	Polyurethane	abeproof PU ECO

PRODUCT SELECTOR

CONCRETE REPAIR & PROTECTION

CRACK INJECTION			
Widths > 0.1 mm	High viscosity crack stabiliser, 90 minute pot life	Epoxy	epidermix ® 365
Widths < 0.1 mm	Low viscosity crack stabiliser, 5 hour pot life		epidermix ® 389
Fill voids and prevent water seepage and ingress in structures	Reacts to moisture to produce a foam, for mining and civil applications	Polyurethane	abe ® PU injection filler foam
FAIRING & REPROFILING			
Smoothing surface imperfections and blowholes	Thin coat, high strength, feather edge	Cementitious	durarep FC
	High strength, feather edge, damp substrate	Epoxy	epidermix ® 505
PRIMERS / ADHESIVES			
Concrete substrates, wet-to-dry adhesive	Shorter open time	Acrylic	durabond GP
	Medium open time	Epoxy	epidermix ® 344
	Long open time		epidermix ® 345
Adhesive, filler and grouting medium	General purpose adhesive for most materials	Epoxy	epidermix ® 372
Steel reinforcing protection	Zinc rich passivating coating		durarep ZR primer
Bonding and steel reinforcement protection	Bonding slurry coat (0.5 mm) and primer coat (2 mm) with active corrosion inhibitors. Alternative to zinc rich or epoxy	Cementitious	durabond SP
Bonding and filling of most construction materials, including concrete to asphalt and tack-bonding of rubber	Solvent free, filled amine cured mastic	Epoxy tar	epidermix ® 315
Additive/bonding primer for cement mortars and screeds	Improves adhesion, tensile and flexural strengths of sand/cement mixtures permitting thin layers	Synthetic resin polymer	duralatex
PROTECTIVE COATINGS			
Carbonation (inland), chloride (coastal) and other water borne contaminants barrier	Coloured, UV stable, flexible system, primer and top coat	Acrylic	duracote WB
Concrete, masonry structures, protection against carbonation, chloride and other water borne contaminants	Elastomeric, crack bridging, UV stable	Cementitious	abe ® silocoat
Fine textured protection coat to concrete, masonry structures against external factors	Elastomeric, crack bridging, UV stable, smooth finish		duracote FT
Waterproofing, protection and repair of new and old concrete structures internally and externally	Flexible, non-toxic, excellent bond to concrete		duraflex ®
Sealing, laminating, screeding and tile grouting	Solvent free, novolac modified, high chemical resistance	Epoxy	abecote ® SF 217
Coating/mortar for protection of asphalt against oil and chemical resistance to concrete and steel	Good wear and chemical resistance	Coal tar epoxy	abecote ® SF 356



CONCRETE REPAIR
& PROTECTION

To view all products, scan this QR code with your smartphone.



REPAIR MORTARS			
Structural reinstatement vertically and overhead and honeycomb repairs	High strength, dual expansion and migrating corrosion inhibitor	Cementitious	durarep GT - MCI
	High strength, fibre reinforced, high build, migrating corrosion inhibitor (MCI)		durarep FR
Concrete pavements and shuttered structural repairs	High strength, fluid micro concrete, migrating corrosion inhibitor (MCI)		durarep FMC
Plugging holes and running water	1 minute set, impervious		durarep 60
	3 minute set, impervious		durarep 180
Adhesive/repair to patching defects in concrete and fibre cement, fabricating components	High early strength and chemical resistant	Epoxy	epidermix ® 318
Bedding mortar/adhesive to patching precast units, concrete surfaces, stair treads, joint arises, honeycombed concrete	High early strength, cures in damp conditions		epidermix ® 319
Structural reinstatement to vertical, overhead defects, honeycomb and spall repairs	High early strength, putty consistency, cures in damp conditions		epidermix ® 314



Bridge Rehabilitation

General Construction, Concrete Repair & Protection Product Solutions

Viaduct segment adhesive

- **epidermix**® 319
- **epidermix**® 350

Joint road sealant

- Dowsil® 890 SL
- Dowsil® 888

Concrete vapour barrier

- flintkote 3

Bridge bearings

- **epidermix**® 324
- **epidermix**® 325
- **duragrout**®

Anchoring railing posts

- **duragrout**®
- **abe**® chemical anchor MAXX
- **epidermix**® 325

Steelworks

- **durarep** ZR primer or **abecote**® 384
- Epoxy coat: **abecote**® 386
- Polyurethane coat: **abecote**® 441
- Epoxy tar: **abecote**® 352

Concrete spalling repair

- **durarep** ZR primer
- Bonding agents: **durabond** GP, **epidermix**® 344 or 345
- Repair mortar: **durarep** FR or GT-MCI
- Rebar grout: **epidermix**® 395 or 396

Concrete curing

- **duracure** acrylic
- **duracure** WPR
- **durabond** GP

Concrete strengthening

- **durafibre** carbon fibre, plate & wrap

Concrete protection coatings

- **duracote** WB
- **duracote** FT
- **durabond** SP
- **duraflex**®

Concrete crack injection/repair

- **epidermix**® 395
- **epidermix**® 365
- **epidermix**® 314 or 319
- **epidermix**® 372

Pre-stress and post-tensioned cables

- **duragrout**® CG

PRODUCT SELECTOR CONCRETE WORKS



To view all
products, scan
this QR code
with your
smartphone.



ADHESIVES			
Structural bonding dry-to-dry concrete, steel and bricks	High strength, non-slump, non-shrink	Epoxy	epidermix® 350
External carbon fibre structural reinforcement, use with durafibre CFP	Non-shrink, excellent adhesion, high strengths and solvent free		durafibre CFP adhesive
Laminating/impregnating resin used in conjunction with durafibre CFW	Solvent free, self-priming and excellent adhesion to substrates		durafibre CFW resin
Bonding mortar/plaster applications and integral admixture	Good bond, economical	Synthetic resin	abebond® plastergrip
Polymer modified cement based mortar adhesive used to bond concrete blocks/bricks together instead of traditional thick mortar bedding system	Provide a thin, excellent adhesion, very strong bond between block/brick faces with water resistant barrier between joints	Cementitious	abefix TBM (thin bed mortar)
COATING/SEALERS			
Water based metal primer and corrosion protection coating	Self-crosslinking, multi-phase acrylic dispersion	Acrylic	4-metal primer
Protective coating for steel, concrete and timber	Corrosion protection to most surfaces	Epoxy coal tar	abecote® 352
Protect cementitious, metallic surfaces, water tanks and piping	Potable water, mild chemical resistance	Bitumen	ravenol
Steel corrosion inhibitor and coating	Quick drying, thixotropic	Epoxy	abecote® 384
Primer/sealer for porous surfaces, concrete, plaster, fibre cement and timber.	Versatile primer for epoxies and polyurethanes, long pot life		abecote® 386
Lining to prevent build-up of low abrasion materials (feed meal silos)	Solvent free epoxy to improve slip factor		abecote® SF 321
Penetrating liquid with hydrophobic properties applied to concrete, stone and face brickwork	Protection against chlorides, carbon dioxide ingress, reduces corrosion efflorescence	Silane siloxane	durasil SH
CURING COMPOUNDS			
Shutter release agent	Excellent release agent, economical	Oil emulsion	durastrap
Curing membrane for concrete, masonry surfaces	Provides temporary membrane to retain moisture in concrete for effective curing. Wax based, can't be overcoated	Wax emulsion	duracure WB
	Multi-purpose curing, sealing and protective membrane for concrete. I.e. external hardstands, concrete roads, plastered surfaces. Can be overcoated	Pliolite resin Clear/White	duracure PR
	Water based, slightly viscous, acrylic emulsion solution which dries to a colourless stain free surface when applied to concrete. Curing aid	Acrylic emulsion	duracure acrylic
	Resin based concrete curing compound. Clear and white pigmented for light reflectance to keep temperature of concrete to a minimum. Meets ASTM requirements. I.e. external hardstands, concrete roads	White Pigmented Resin	duracure WPR
	Liquid membrane-forming solvented curing compound i.e. over dryshake abecron floors	Solvent based Clear	duracure SBC
GROUTING			
Grouting and anchoring bars, bolts and fixing steel into concrete, high strength masonry, brick and rock	Applied under water, cures in 45 minutes. Rapid strength gain, pourable and paste consistency	Polyester	epidermix® 725 epidermix® 725 TX
Anchoring into solid substrates and for use in dry, wet and flooded holes	Vinylester formulated, free of styrene, has a very low odor and is ideal for use in confined spaces and indoors	Vinylester	abe® chemical anchor MAXX
Concrete windfarm tower joint grout between keystones	V- vertical joints H - horizontal joints	Cementitious	duragrout® WF

GROUTING			
Steel windfarm towers grout under flanges	High performance precision grout	Cementitious	duragrout® HP
Machine, column, crane rails, wind farm bases and anchor bolts	Fluid, rammable, non-shrink, high strength precision grout		duragrout®
Bridge bearings, machine and column bases, anchor bolts	Flowable, high strength	Epoxy	epidermix® 324
Bridge bearings, machine bases, structural elements	Rammable, high strength		epidermix® 325
Starter bars vertically down	Quick setting, flowable, structural and chemical resistant		epidermix® 395
Starter bars horizontally or overhead	Quick setting, non-flow, structural and chemical resistant		epidermix® 396
MORTARS			
Durable protection layer to fibre cement, insulation boards, rock and concrete wall surfaces	Good bond, flexural and tensile strengths, economical, paintable and reduced permeability	Cementitious	abe® mortar clad
General purpose white Portland cement	Aesthetic and decorative, high strength		abe® CEM-blanc
Fast setting patching mortar for concrete and pavement structures	High-early final compressive strengths, self-compacting, chloride free and non-shrink		durarep FS
Polymer modified high-strength concrete reinstatement mortar with excellent compatibility with concrete in terms of movement	Structural, good abrasion resistance, high compressive strengths, chloride and carbon dioxide resistant		durarep HS
Polymer modified, shrinkage compensated cementitious patching compound in concrete	Fibre reinforced, chloride free, non-toxic, applications 5 – 40 mm thick		durarep P&S
Smoothing of irregular surfaces and blow holes on concrete and masonry to provide a suitable chemical resistant finish	Provides an easy workable, trowel applied, thixotropic, non-slump consistency, to receive an appropriate chemical top coat	Epoxy Cement	durarep EC
High strength repair compound for concrete, masonry and brickwork, joint arises, stair treads, precast units	Chemical resistant, cure under damp conditions, high-early/ultimate final compressive strengths	Polyester	epidermix® 715
AUXILIARIES			
Prevent regress or ingress of water/liquids through joints in water retaining structures	Withstands a 10 m head of water	Polyvinyl chloride waterstops	durajoint PVC waterstops
Seal water retaining structure joints > 10 mm movement	Withstands a 50 m head of water	Rubber waterstops	durajoint rubber waterstops
Integral sealing for construction joints in case in-situ concrete where space or access restricted	Seals by immediate swelling and by crystallization	Swellable waterstop-bentonite	durajoint SW-B
Integral sealing for prefabricated concrete joint construction under conditions of confinement	Seals joints in tunnels and shafts	Swellable waterstop-rubber	durajoint SW-R
Provides excellent extension in cross direction and rigid lengthwise as well as strong high-tenacity joint/crack sealing	High pressure resistance, excellent lateral and longitudinal elongation bandage, 1.5 mm. Used with duraflex® or epidermix® 318. I.e. culverts	Polypropylene, special coated non-woven waterproofing tape	duraband
Repairing/sealing of expansion, construction, contraction joints	High performance waterproofing bandage, 2 mm. Asphalt tolerant.	Thermoplastic elastomers	durajoint flexband system
Repairing / patching defects in concrete	Light weight, quick turnaround time for repair work	Carbon fibre plate	durafibre CFP
Offers outstanding tensile strength for bending loads, deformation, or increased stress and E-modulus for the structural strengthening of reinforced concrete elements	Light weight, quick turnaround time for repair work	Carbon fibre fabric/ wrap	durafibre CFW
12 mm circular rod for new-surface-mounted structural strengthening of concrete, bonded and fully encapsulated	Light weight, quick turnaround time for repair work	Carbon fibre rod	durafibre rod

PRODUCT SELECTOR

FLOORING

To view all
products, scan
this QR code
with your
smartphone.



DRY SHAKES			
Surface hardener for light moderate traffic	High abrasion and impact resistance, metallic aggregate, industrial floors	Cementitious	abeplate
	High abrasion and impact resistance, natural mineral aggregate, industrial floors		abe cron
	High abrasion resistance, natural, level assist, dustless		abecron LA
COATINGS			
Light duty applications	Sealer, enhance performance/finish	Epoxy	abecote® 436
	Durable, damp substrate, water based		abecote® 337 tough epoxy paint
	Durable, decorative, enamel		abecote® 320
Medium duty applications	Hi-build, durable and decorative	Polyurethane	abecote® 400 HB
	High abrasion resistance, natural		abecote® clear PUD
	Durable, hardwearing, decorative with clear gloss or clear matt finish		abecote® tough PU paint (clear)
For cementitious systems	Decorative, chemical, UV and abrasion resistant		abecote® 441
	Sealer, moisture insensitive, clear	Acrylic emulsion	abeseal finisol
Heavy duty applications	Very high chemical resistance	Epoxy	abecote® SF 217
	High chemical resistance, flexible, cold tar		abecote® SF 356
		Aliphatic PU coating, clear matt and gloss finish	Polyurethane
Epoxy binder system, sealer and primer	Solvent free, clear, low viscosity, less sensitive to humidity and moisture	Epoxy	flooring resin kit
SCREEDS			
Floor repairs, light to medium duty	Flowable and hard wearing	Cementitious	aberep 710
Rapid fix mortar for patch repairs in concrete floors	Dustless, chloride free, fast setting 30 MPa in 28 days		aberep FS
Medium duty applications	Self-levelling, decorative, chemical resistance	Epoxy	abeflo
	Flexible, heat and chemical resistance	Polyurethane	abeflo HPU
Heavy duty applications	Flexible, hard wearing, self-healing	Bitumen	abeco® mastic
	Non-metallic, ultra high strength and abrasion resistance, granolithic type floor	Cementitious	abedur S
	Very high chemical resistance	Epoxy	abecote® SF 217
	High chemical resistance, cold tar		abecote® SF 356
	Chemical abrasion resistance, decorative		abescreed
		Self-levelling, flexible, heat and chemical resistance	Polyurethane
Self-smoothing	Rapid hardening cement based screed for levelling floors where quick setting is essential.	Cementitious	abescreed SLCP FS
	Fast track, pumpable, trafficable underlayment		abescreed SLCP 25
			abescreed SLCP 15
	Fast track overlay, non-shrink 6 - max 30 mm smoothing and raising		abescreed duraTop

DECORATIVE CONCRETE SOLUTIONS			
Medium duty applications	General purpose white Portland cement (CEM II/B-L 42,5N)	Cementitious	abe® CEM-blanc®
CASE HARDENING			
Anti-dusting	Case hardened, tough surface, chemical bonding	Silicate solution	abe® Conseal
ADHESIVES			
Screeds	Wet-to-dry bonding, excellent adhesion	Epoxy	epidermix® 116
Screed adhesive	Improves adhesion and strength	Resin polymer	duralatex
Bitumen screed and coating	Versatile screed	Bitumen	flintkote 3 abeco® mastic
Screed adhesive	Promote keying for concrete screed sub-floors, epoxy coating, smooth surfaces, and impermeable surfaces like tiles prior to the application of self-levelling screed like abescreed SLCP 25	Acrylic emulsion slurry	abe® keying slurry
PRIMERS			
For steel	Anti-corrosive, single pack	Epoxy	abecote® 384
For steel and other porous surfaces	Primer and undercoat		abecote® 386
For epoxy flooring systems	General purpose, solvent free, chemical resistant		abecote® primer
For green concrete	Curing, sealing and primer		abeprime GCP
For cementitious systems	Sealing and adhesion	Acrylic emulsion	abeprime SLC acrylic primer
For abescreed and abeflo HPU systems	Adhesion, pore sealer and moisture barrier	Polyurethane	PU/HPU Primer
For concrete floors	Reduce moisture vapour emission through concrete, solvent free	Epoxy	abecote® vapour barrier
COVING/WALL RENDER			
Heavy duty coving and wall render	Chemical resistance, high/low temperature	Polyurethane	abescreed PU CG
CURING			
Concrete curing	ASTM C309 curing compound	Solvent based	duracure SBC
CLEANING AGENT			
Cleaning Agent	Commercial Grade	Medium alkaline, degreasing detergent cleaner	abefloor cleaning agent CG

PRODUCT SELECTOR

SEALANTS & ADHESIVES

LOW MOVEMENT EXPANSION AND CONTRACTION JOINT			
Chemical plants and high trafficked joints	Chemical resistant, damp substrate bonding	Polyurethane/ Epoxy/Tar	flexothane® CTW
Chemical plants, factory and warehouse floors	Fuel, chemical and abrasion resistant	Polyurethane/ Epoxy	flexothane® EPU
	Reinforcing joint filler for heavy wheeled traffic floors, semi-rigid, 65 Shore A hardness	Polyurethane	flexothane® 65 P
	Reinforcing joint filler for heavy wheeled traffic floors, semi-rigid, 80 Shore A hardnenss		flexothane® 80 P
Horizontal joints in trafficked premix and concrete surfaces	Hard resilient sealant which resists ingress of grit, protects arises of joints, extends the life of a road. Require the road to be either resealed or re-laid	Bitumen	flexoplastic B
ADHESIVES			
Slot sealing compound in roads, runways, hardstands, aprons and car parks	Cold applied, pourable, self-levelling and fast setting	Epoxy tar	epidermix® 316
Joining metal or cementitious water main pipe sections	Epoxy adhesive/grout and patching compound	Epoxy	epidermix® 338 HBT
Adhesive, filler and grouting medium	General purpose adhesive for most materials		epidermix® 372
Universal primer for a.b.e.® polysulphide (durakol) and polyurethane (flexothane) elastomeric joint sealants on porous surfaces	Low viscosity primer for optimum adhesion, solvent borne, not used with flexothane HS and flexothane CTW		epidermix® 326
Structural adhesive for most building materials	Structural dry-to-dry epoxy adhesive	Polyurethane modified epoxy	epidermix® 350
Fixing 22 mm woodblock flooring	Economical, solvent free, woodblock adhesive	Bitumen	grip-a-bloc
Wet and dry bonding and sealing	Bonds and seals most materials	Scypolymer	theWORKS PRO
MANHOLE SEALANTS AND BUTYLS			
Manhole and concrete butt joint sealing	Cold applied, pre-formed, pressure sensitive sealant	Bitumen	abe® bitumen manhole sealer
Manhole and low movement vertical and inclined joints	Cold applied, jointing compound	Modified bitumen	abe® bitujoint putty
Sealing of concrete butt joints in precast elements	Cold applied, solvent free pre-formed butyl sealant	Butyl rubber	abe® butyl joint sealer
GENERAL SEALING			
Gap filling, paintable sealant	Fast cure, flexible, paintable	Acrylic	abe® Painters Mate
Non-porous, non-cementitious materials	High strength, 100% silicone, MAF 25%	Acetoxo	DowSil™ 781
	Weatherseals, non-corrosive, low odour	Neutral cure	DowSil™ 799
Porous and non-porous surfaces	Weatherseals, expansion and perimeter joints		DowSil™ 813C
	Construction joint sealer and crack filler, wide movement areas	Hybrid	flexothane® 15
	Construction joint sealer, crack filler and adhesive, low movement areas, 45 Shore A hardness		flexothane® 25
STRUCTURAL GLAZING			
Structural bonding of glass and metal	One component, high tensile strength, factory applied.	Neutral Cure	DowSil™ 895
	Two component, pump applied		DowSil™ 993

To view all products, scan this QR code with your smartphone.
 

INSULATED GLAZING			
Insulated glazing sealant for structural glazing	Low water absorption, secondary seal for IG units	Neutral Cure	DowSil™ 3362
AUXILLIARIES			
For forming expansion joints or as backing material for joints	Suitable for water retaining structures (durasheet 100)	Polyurethane	duracord and durasheet 40/100
MEDIUM MOVEMENT EXPANSION AND CONTRACTION JOINTS			
Civil engineering structures, reservoirs and floors	Chemical, biological resistance and potable water	Polysulphide	durakol® G HM
High rise structures, floor and general building joints	Water and certain chemical resistance		durakol® G LM
Floors, canals and horizontal joints	Pourable, self-levelling joint sealant		durakol® P LM
Concrete, brickwork, steel, aluminium and ceramic tiles	Elastic, low modulus, gun grade, moisture curing	Polyurethane	flexothane® 27
Civil engineering structures, reservoirs and floors	Raw water, sewage and reticulation works		flexothane® G
	Raw water, sewage works, bacteria resistance		flexothane® P
Pavements, garage forecourts, fuel depots	Flexible, self-levelling, fuel and chemical resistance	Polyurethane/Tar	flexothane® HS
PANEL BONDING			
For panel bonding applications that require high durability and fast handling	Instant green strength directly after application	Neutral cure	DowSil™ 896 PanelFix
Suitable for cladding panels in rainscreen/ventilated façade designs	Provide load support for panel bonding applications	Spacer tape	DowSil™ PanelFix Tape
Adhesion promoter for use on natural stone, masonry and glass fibre-reinforced concrete	Resists adhesion degradation due to water immersion	Silane Resin	DowSil™ Primer P
HIGH MOVEMENT CONSTRUCTION AND EXPANSION JOINTS			
Concrete contraction and expansion joints	Seals irregular surfaces, fuel resistant, UV stable	Silicone	DowSil™ 888
Concrete and asphalt construction and expansion joints	Seals irregular surfaces, fuel resistant, self-levelling		DowSil™ 890 SL
Concrete and steel bridge expansion joints	Seals irregular surfaces, self-levelling, rapid cure		DowSil™ 902 RCS

a.b.e.® is your trusted partner for comprehensive solutions for Waterproofing, Grouts and Mortars, Concrete Works and Construction Chemicals, Flooring, Sealing and Glazing, and Technical Adhesives. Experience the synergy of quality and innovation across these segments.

PRODUCT RANGE	INFRA-STRUCTURE	INDUSTRIAL	COMMERCIAL BUILDINGS	RESIDENTIAL BUILDINGS
Concrete Works	✓	✓	✓	✓
Sealants and Adhesives	✓	✓	✓	✓
Waterproofing	✓	✓	✓	✓
Protective Coatings	✓	✓	✓	✓
Concrete Repair & Protection	✓	✓	✓	
Flooring		✓	✓	✓